

ROLLER DOOR OPENER

Mechanical Installation

WARNING:

- Please read the manual carefully before installation and use.
- The installation of your new door opener must be carried out by technically qualified or licensed person.
- Attempting to install or repair the door opener without suitable technical qualification may result in severe personal injury, death and /or property damage.

CONTENTS

IMPORTANT SAFETY RECOMMENDATIONS.....	1
1.PACKAGE CONTENTS	2
2.TOOLS REQUIRED.....	3
3.DOOR REQUIREMENTS	3
4.PRE-INSTALLATION RECOMMENDATIONS.....	4
5.ATTACHING THE WEIGHT BAR.....	4
6.CURTAIN FIXING(IF REQUIRED).....	5
7.THE RELEASE HANDLE & CORD.....	5
8.OPERATING THE MANUAL RELEASE	6
9.LEFT/RIGHT SIDE INSTALLATION.....	7
10.ATTACHING EXTENSION BAR (IF REQUIRED).....	7
11.INSTALLATION PROCEDURE	7

Installation Instruction

IMPORTANT SAFETY RECOMMENDATIONS

WARNING

• **FAILURE TO COMPLY WITH THE FOLLOWING SAFETY RECOMMENDATIONS MAY RESULT IN SERIOUS PERSONAL INJURY, DEATH AND / OR PROPERTY DAMAGE.**

• **PLEASE READ CAREFULLY AND ADHERE TO ALL SAFETY AND INSTALLATION RECOMMENDATIONS.**

1. The opener is designed and manufactured to meet local regulations. The installer must be familiar with local regulations required in respect of the installation of the opener.
2. Unqualified personnel or those persons who do not know the occupational health and safety standards being applicable to automatic gates and other doors, must in no circumstances carry out installations or implement systems.
3. Persons who install or service the equipment without observing all the applicable safety standards will be responsible for any damage, injury, cost, expense or claim whatsoever any person suffered as a result of failure to install the system correctly and in accordance with the relevant safety standards and installation manual whether directly or indirectly.
4. For additional safety we strongly recommend the inclusion of Photo Beam. Although the opener incorporates a pressure sensitive Safety Obstruction Force system the addition of Photo Beam will greatly enhance the operating safety of an automatic garage door and provide additional peace of mind.
5. Make sure that the garage door is fully open & stationary before driving in or out of the garage.
6. Make sure the garage door is fully closed & stationary before leaving.
7. Keep hands and loose clothing off the opener and garage door all the time.
8. The Safety Obstruction System is designed to work on STATIONARY objects only. Serious personal injury, death and / or property damage may occur if the garage door comes into contact with a moving object
9. This appliance is not intended for use by persons (including children) with reduced physical, sensory or mental capabilities, or lack of experience and knowledge, unless they have been given supervision or instruction concerning use of the appliance by a person responsible for their safety. Children should be supervised to ensure that they do not play with the appliance.



10.  Waste electrical products should not be disposed of with household waste. Please recycle where facilities exist. Check with your local authority or retailer for recycling advice.
11. If the supply cord is damaged, it must be replaced by the manufacturer, its service agent or similarly qualified persons in order to avoid a hazard.
12. Do not allow children to play with door controls. Keep remote controls away from children.
13. Watch the moving door and keep people away until the door is completely opened or closed.
14. Take care when operating the manual release since an open door may fall rapidly due to weak or broken springs, or being out of balance.
15. Frequently examine the installation, in particular check cables, springs and mountings for signs of wear, damage or imbalance. Do not use if repair or adjustment is needed since a fault in the installation or an incorrectly balanced door may cause injury.
16. Each month check that the drive reverses when the door contacts a 40mm high object placed on the floor. Adjust if necessary and recheck since an incorrect adjustment may present a hazard, for drives incorporating an entrapment protection system depending on contact with the bottom edge of the door.
17. Disconnect the electric power when cleaning or carrying out other maintenance.

NOTE: If your garage has no service entrance door, we recommend an outside quick release must be installed. This accessory allows manual operation of the garage door from outside in case of power failure,.

Installation Instruction

1.PACKAGE CONTENTS

1. Instruction manual
2. Clamp bracket,plates,washers (2) and nuts (2)
3. Weight bar
4. Transmitter (2)
5. Weight bar screws(2) and nuts(2)
6. Warning label
7. Self-tapping screw (2) (Used for fixing door curtain)
8. Release handle
9. Motor

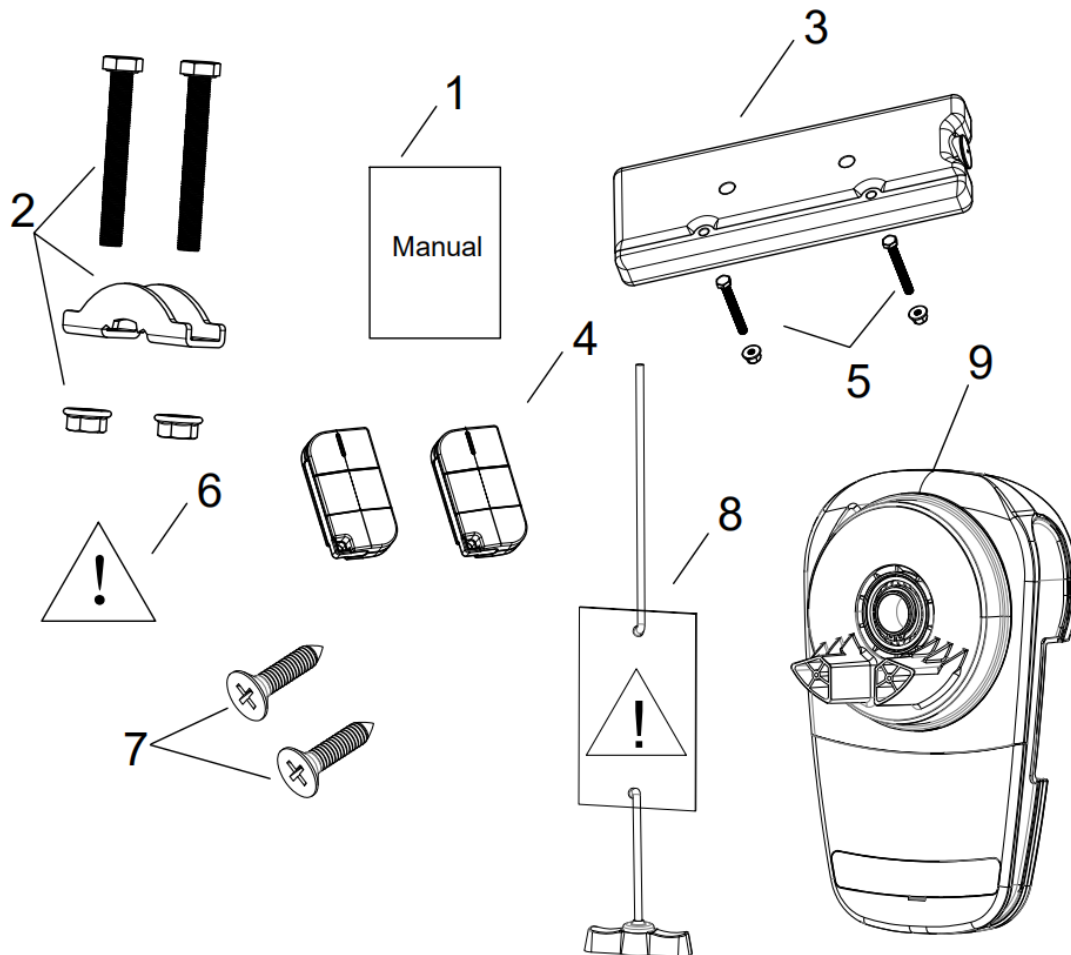

Installation Instruction

2.TOOLS REQUIRED

1. Marker pen
2. Adjustable wrench for U-bolts already installed on the door (2)
3. Philips-head screwdriver
4. Rope
5. Drill and 6.5mm drill bit
6. Ladder
7. 8mm, 10mm, 13mm sleeve 300mm extension sleeve (for narrow side mounting) and socket wrench

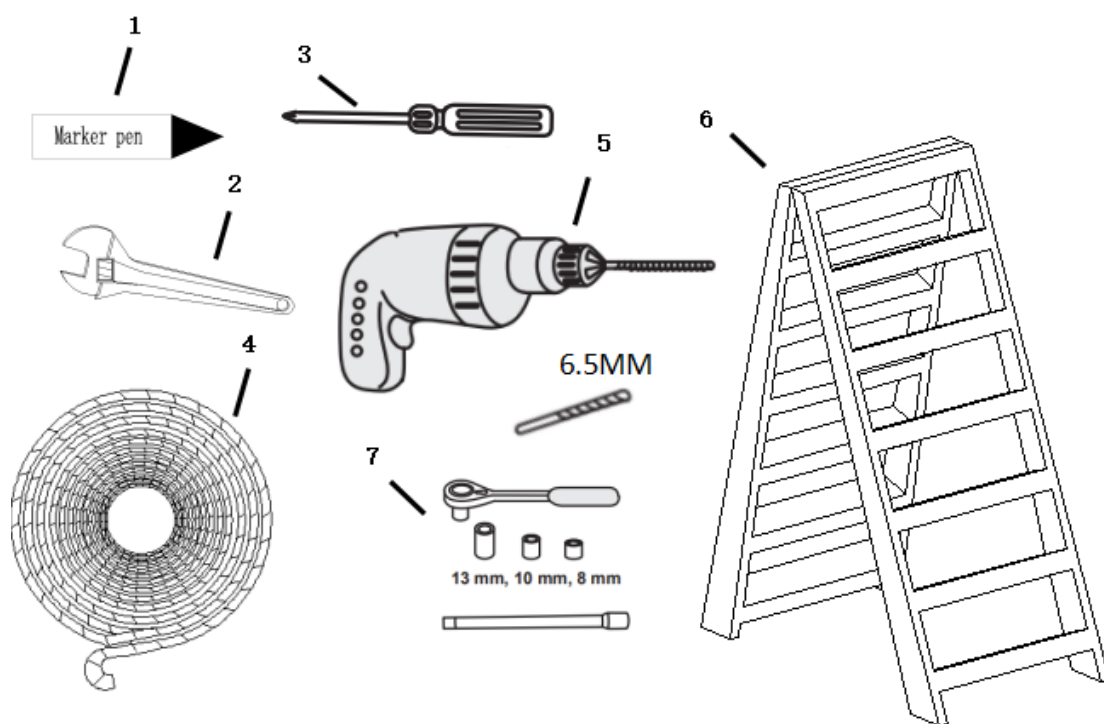

3.DOOR REQUIREMENTS

- 1、 Maximum door weight of 130 kg.
- 2、 Maximum door height of 5 m.
- 3、 Maximum curtain area of 20 m².
- 4、 Protector System (Photo cell) must be installed if the force at the edge of closing Door exceeds 400N (40 kg)
- 5、 Applicable to door shaft diameter range is

$$34^{+1}_{-0.5} \text{ mm} / 32^{+1}_{-1} \text{ mm (Optional) }。$$

- 6、 Ensure that there is at least 40 mm from edge of the curtain to the edge of the bracket. If the clearance is small, the rolling door opener cannot be installed, please increase the clearance before installation.

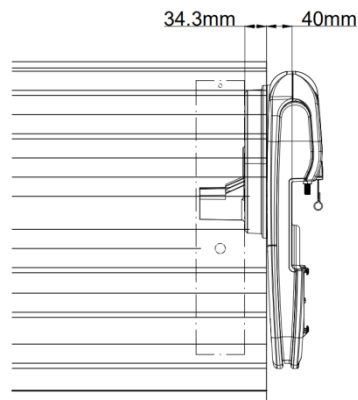

Installation Instruction

Note: Main Opener body thickness: 88mm (Not including wheel drum). Motor Opener body thickness after lithium battery installed: 93mm (Not including wheel drum).

4. PRE-INSTALLATION RECOMMENDATIONS

Please complete the following test under no other force than the torsion force of the door spring to ensure good balance of the door:

- 1、 Raise and lower the door to determine if there are any sticking or binding points (20 kg is the absolute maximum allowable to raise or lower the door in any position).
- 2、 Do not lock the roll door or remove any rope connected to the roll door.
- 3、 Lift the door about halfway up and then release it. The door should be balanced by the spring rebound.
- 4、 Before installing the motor, if the roller door is not balanced in place, a qualified roller door installation technician is required.

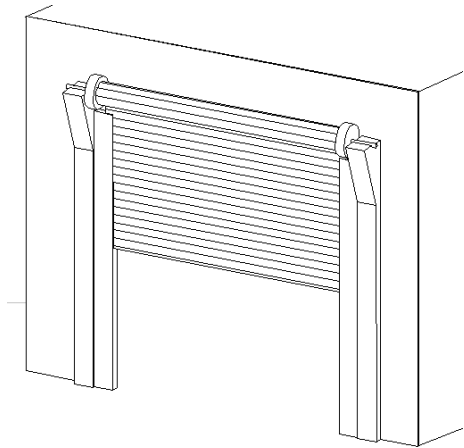

Note: This motor shall not be installed in a damp space or exposed to the outdoors. After installation of the roll door, ensure that the part of the roller door is not extended on the public or pavement. The motor shall not be installed on the roll door with a pass-door.

5. ATTACHING THE WEIGHT BAR

If the door has a lifting handle, remove the handle, nuts&bolts. Place the weight bar over the handle holes, insert the extended bolts through the weight bar & fasten the handle back in place.

- 1、 Place the weight bar in the centre of the door as shown.

If the door curtain does not have a handle you will need to follow these instructions:

- 2、 Place the weight bar in the middle position below the inside of the door and use the marker pen to make two holes through the screw holes.
- 3、 Drill two holes with a 6.5mm drill bit.
- 4、 Use the bolts, washers and nuts(provided) to fasten the weight bar in place.

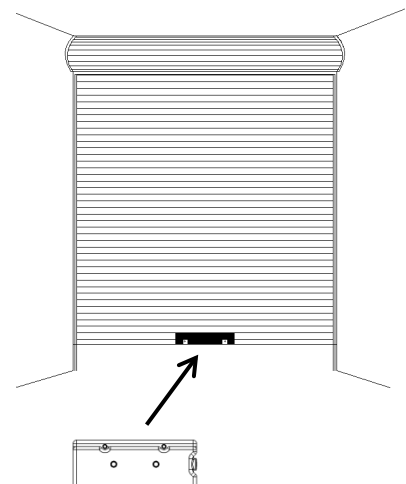

Installation Instruction

6.CURTAIN FIXING(IF REQUIRED)

Note: To make sure whether the curtain and drum wheel fixed by two screws or more, if not, in order to there is no balloon, insert the supplied self tapping metal screws into where the curtain leaves the roll. Secure these through the curtain into the drum wheel at each end of the roll. First, close the door curtain under normal conditions and there is no balloon on the top of the door curtain, use a second self-tapping screw to fix it at a semicircle away from the first screw fixing position, as shown in the figure.

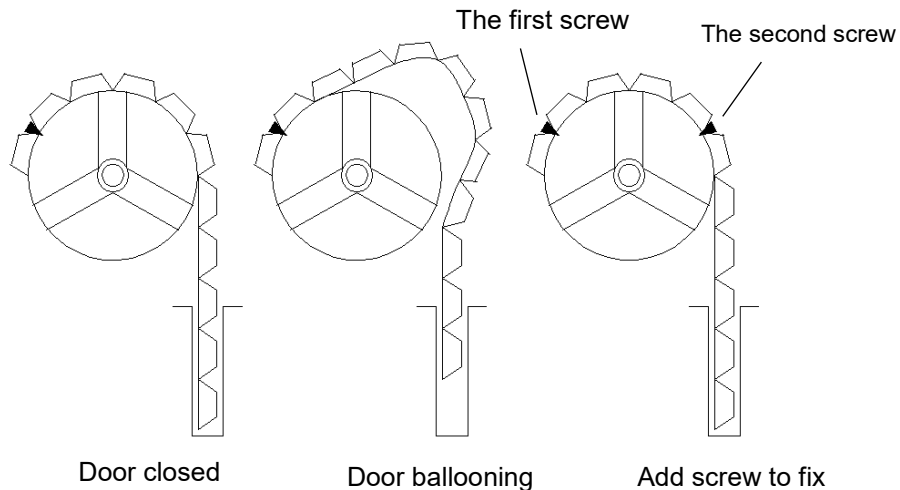

7.THE RELEASE HANDLE & CORD

The manual release mechanism enables the door to be manually operated during power outages or in an emergency locking.

- 1、 Please install the provided clutch extension cord to the ring-pull of the opener and ensure it is firm.
- 2、 When the power outage, please release the handle, so that the door can be controlled by hand.
- 3、 The RED Manual Release cord is preassembled to the opener. When the opener is installed the handle should be no higher than 1.8 metres from the floor. The cord may need to be extended for high door installations.

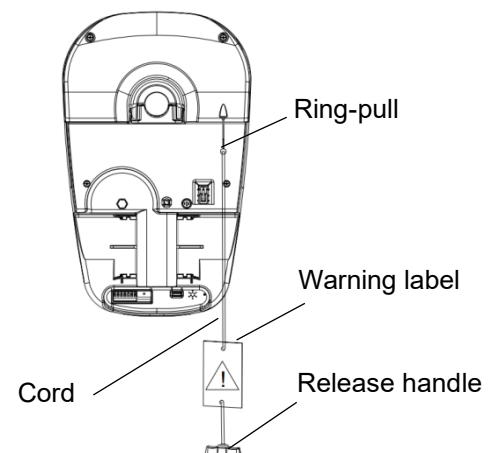

Installation Instruction

8. OPERATING THE MANUAL RELEASE

Note: Be careful when operating the clutch, because if the torsion spring fails in the door, the door will momentarily close when the clutch is released, which may cause personal injury and property damage;

Release the clutch: When the clutch is locked, pull the clutch handle down manually. When you hear a click sound then release the clutch handle, the clutch is released and you can manually open and close the door.

Locking the clutch: When the clutch is released, pull the clutch handle down manually. When the clutch handle is released when a click sound is heard, the clutch is locked and the door motor can be used to open and close the door.

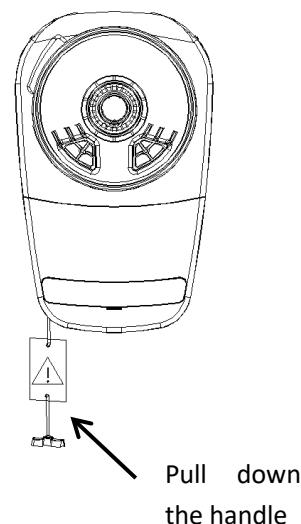

Installation Instruction

9.LEFT/RIGHT SIDE INSTALLATION

LEFT

(To install in this direction, you need to switch the installation direction before setting the function. The switching steps refer to section 12, 2-6 installation mode Settings of left/right)

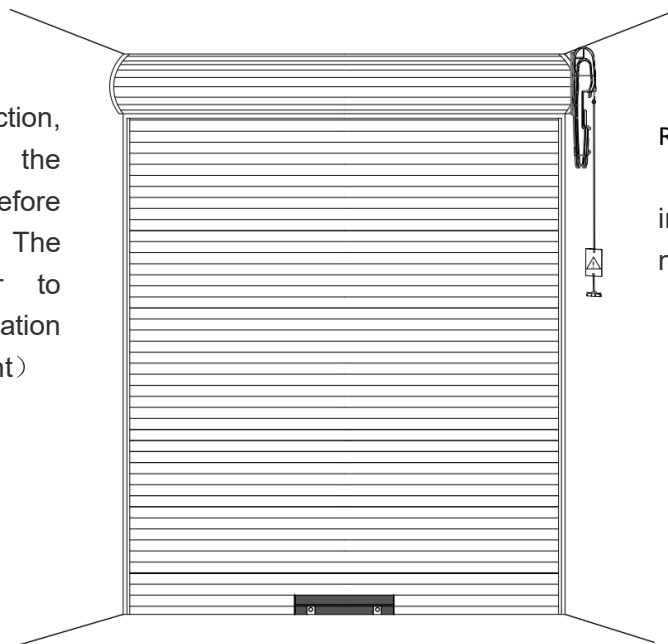

Inside garage looking out

RIGHT

(Factory default setting installation direction, no need to adjust)

10.ATTACHING EXTENSION BAR (IF REQUIRED)

If the drive leg does not touch the roll door and reel spokes, the extension poles needs to be installed:

- Insert the extension poles into the drive legs.
- Align the holes on the extension poles with the holes on the drive legs.
- Using the screws provided, secure the extension poles.

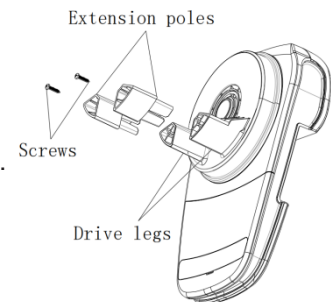

11.INSTALLATION PROCEDURE

Note: The opener can be installed on either side of the door. The following instructions are for **RIGHT HAND INSTALLATIONS**.

- Ensure the saddle U-BOLT at the end opposite opener side are securely fastened.
- Completely open the roller door. Tie the safety rope in the middle of the door. Do not tie the rope too tightly to avoid damage to the door.
- Mark the position of the door axle on the bracket, use a ladder or a suitable pillar to support the roller door, and then open the saddle U-BOLT on the opener mounting end side to unload the bracket.
- After release the opener clutch, the opener sungear assembly can rotate freely and then slide the opener over the door axle and engage the drive legs into the door drum wheel, push the

Installation Instruction

opener sungear assembly as far as possible (without disturbing the roller door) and ensure that one of the reel spokes is completely between the sungear assembly axle or extension poles of the opener.

- Install the bracket to replace the roller door axle to the position marked by the wall bracket for locking and fixing.
- After the motor is fixed on the door shaft using a saddle (preload approx. 28-30N.m).
- Remove all ropes and the support stand.
- For the operation of manual inspection door, the manual lifting and lifting shall operate smoothly without any obstruction, and the clutch handle shall be about 1.8m above the ground.

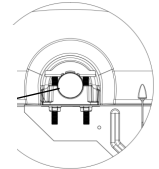
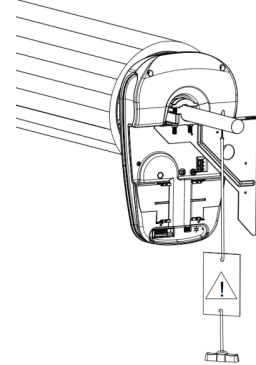
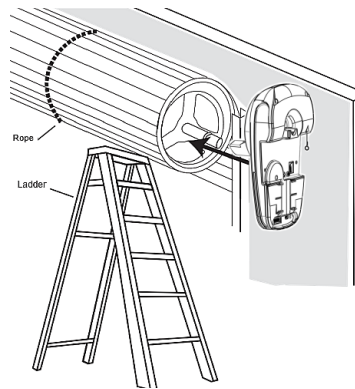
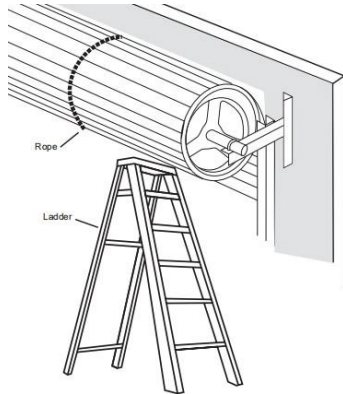

Saddle bolt